

KASON INDUSTRIES, INC

Model 1810LX 4' LED Light Fixture

Installation Instructions:

1. Unpack fixture and remove all packaging. Remove Tray and remove sub-packs. (Keep Tray tethered).
2. Mount fixture using supplied brackets or by screws through the housing. (See figure below for screw locations). Use hardware sufficient to support the weight of the fixture and associated conduit.

- Mount with Brackets -

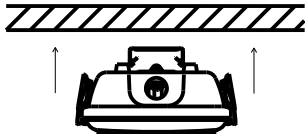

Line up both Brackets and snap Housing into place using even force.

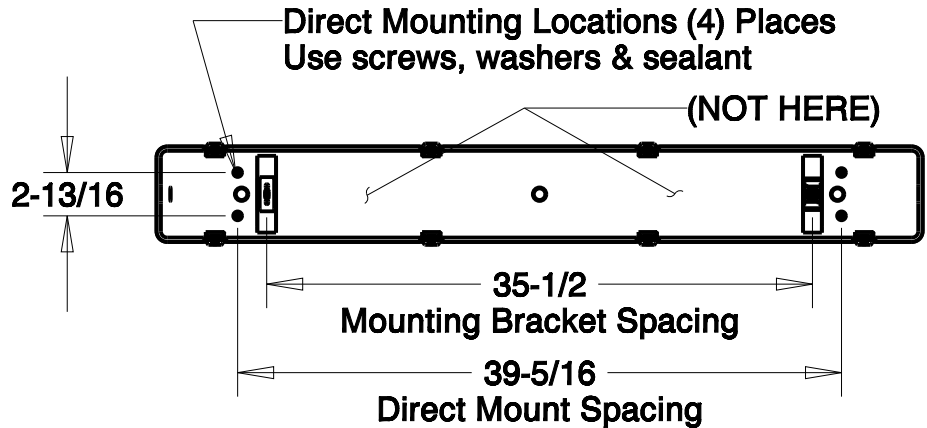

3. Mount conduit hub into open end of housing and wire as required - Hot to Black, Neutral to White. Ground wire at marked location on Tray.
4. Fill conduit around wires with sealant. (PROVIDED)
5. Snap the Tray into place. Check for security.
6. Install the Lens Clips and lock the Lens in place. (Lens must be seated into gasket channel with all latches to provide water tightness)

ATTENTION:
Fill conduit around wires with sealant

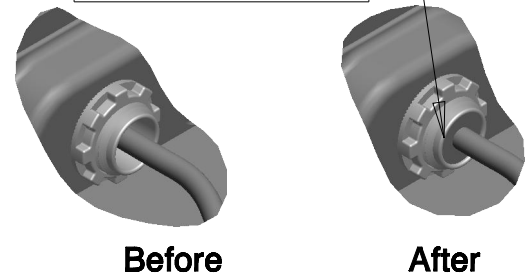

WARNINGS AND CAUTIONS:

- A. Installation by an electrician must comply with Local and National Electrical Codes. The manufacturer assumes no responsibility for improper installation, or application of this lighting fixture.
- B. All supply wires must be suitable for 90° C.
- C. Turn off all electricity before installation. Electricity should be turned off prior to servicing.
- D. This "FIXTURE MUST BE GROUNDED".
- E. Verify a secure connection at the mounting brackets. Use a direct mounting method if the brackets fail to snap securely to the housing.
- F. When used, the HUB shall be connected to the conduit before connecting to the luminaire.
- G. NO SERVICEABLE PARTS.
- H. Sealing of wire opening is necessary to prevent condensation from forming and water collection inside the fixture. Failure to properly seal fixture will VOID warranty.

MODEL#	DESCRIPTION
1810LX4000	LIGHT 4FT, 40W, 0.6A, 120-277V, 4500K

For additional information contact your local KASON representative at (800)-93-KASON

GreenGuard
BY KASON INDUSTRIES