



Project Name _____
 Location _____
 IDN# _____ Quantity _____
 Catalog# _____

1908 Weather Proof Switch

Part Numbers: 1908000602
 1908000603
 1908000604

FEATURES

- Durable Construction: Cover plate made of stainless steel over molded with premium grade silicone
- Multi Function: Kason’s innovative design integrates a Single and Three-Way Switch in one model to simplify purchasing and inventory
- Pilot Light Built in for Easy Illumination: Eliminates the need for additional components
- Flexibility: Built in indicator can be wired as “night light” or “lights on” to meet all of your needs
- Reduced installation Labor: Spade wire terminals for easy and fast installation
- Ideal solution for “wet locations”, indoor and out

SPECIFICATIONS

Electrical Ratings

- 20 amp @120 VAC General Use
- 5 amp @125 VAC Tungsten
- 5 amp @250 VAC Ballasted
- 4.9 amp @ 125 VAC Electronic Ballast

1908-603 - Single and Three-Way Switch with Indicator Light

- Indicator: Neon
- Circuit: SPDT + Indicator
- Approvals: UL Recognized and NSF Component
- Connection: 1/4” Spade male terminal

1908-604 -Four-Way Switch with Indicator Light

- Indicator: Neon
- Circuit: DPDT + Indicator
- Approvals: UL Recognized and NSF Component
- Connection: 1/4” Spade male terminal

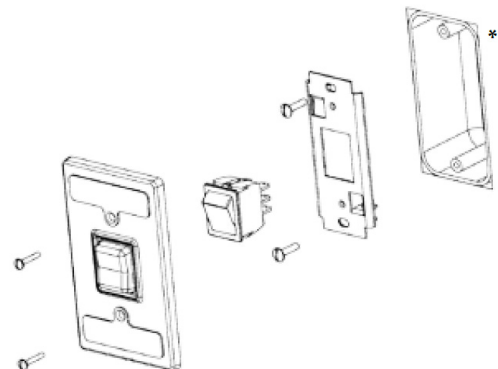
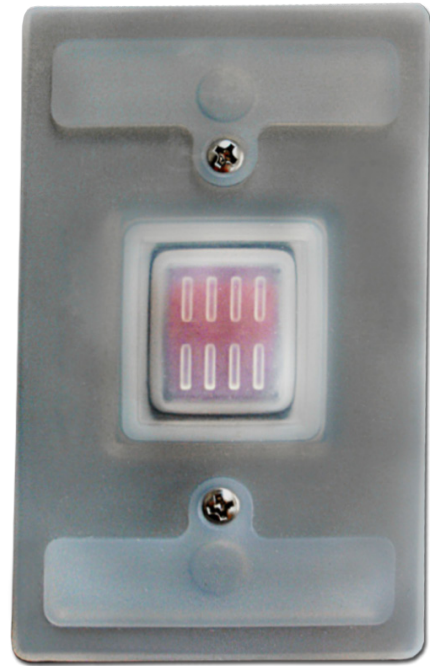

Model No.	Description
11908000602	Weatherproof Rocker Cover
11908000603	Weatherproof Rocker Switch, Single or 3-Way
11908000604	Weatherproof Rocker Switch, 4-Way

* ACCESSORIES(Sold Separately)

- 3ELE0000104 – 2 1/8” Deep Junction Box

Approvals

Date